

General Remarks

About our shipment

PLEASE READ THIS BEFORE USING OUR PRODUCTS

1. Product packaging

Our products are being shipped in custom-made crates with dimensions of 4100 x 1270 mm – height varies according to order volume.

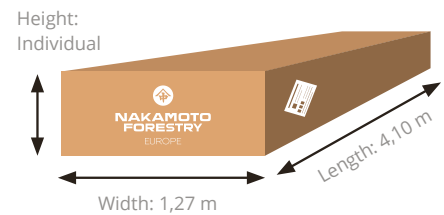

2. Offload of the crate(s)

Please ensure a contact person to be present at the site at the time of delivery – unsuccessful delivery will cause additional cost. In most cases, a forklift will be necessary to offload from the truck. Please be aware that this is not included in the delivery and is also not the responsibility of the trucking company. Should this be difficult to organise for you, please let us know beforehand.



The crate generally can be offloaded sideways from the truck with a forklift. If necessary to offload from the back, a pallet grabber or pallet chain can be helpful to pull it out of the truck. We have a video to show how this is done, so please ask for us to send in case this may be helpful.



3. Acclimatisation of the products

Before installation, all boards should be acclimated to the jobsite location. We recommend acclimating for several days, better 1-2 weeks at a dry place in nearby shade in order to get moisture at equilibrium. The longer it can acclimate, the less movement there will be after installation.

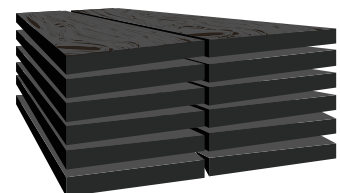

Installation Guidelines

Correct treatment and installation
of Yakisugi boards

PLEASE READ THIS BEFORE USING OUR PRODUCTS

GENERAL GUIDELINES PRIOR TO INSTALLATION

1. Pre-sorting of the products

Our products are completely natural products, therefore colour fluctuation between the individual boards despite being the same species are inevitable. Therefore, before installation please sort the boards by colour tone in order to create a balanced overall appearance – e.g. from darker to brighter or more beautiful boards for the front, less beautiful ones for less visible parts of the façade.

The additional effort to do the pre-sorting exercise is advisable to make it blend in appropriately.

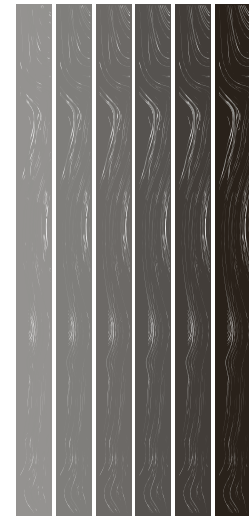

2. Caution during processing

Due to the burning and charring process, the surface of our products is sensitive to pressure. There may also be soot residues on the back of the boards. Please be aware during installation to avoid damage to the surface by pressing or jolting too hard or leaving fingerprints on the surface. Therefore, we strongly recommend to wear gloves during installation.

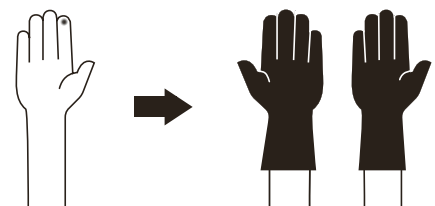

Installation

Guidelines

PLEASE READ THIS BEFORE INSTALLING OUR PRODUCTS

GENERAL GUIDELINES FOR INSTALLATION

1. Furring

Our products will generally be applied to ventilated curtain walls or rainscreens. It is important to ensure that the cladding can dry and waterlogging is avoided. The joint widths are to be selected according to the local climate.

2. Fasteners

We recommend stainless steel ring or screw-shank headed nails or wood screws with a minimum length of 2 ½ times of the thickness of our product (usually 15mm).

3. Fastener spacing

For an optimal hold and to avoid cupping, fasteners should be placed every 40 cm with an edge distance to the grain of at least 2 cm. At least 5 cm edge distance should be maintained in the grain direction. Pre-drill the boards and then countersink the screws or nails flush with the surface.

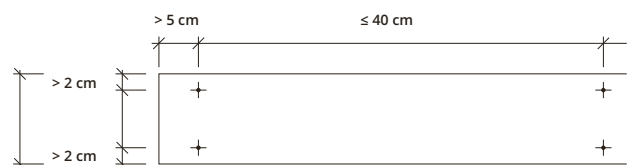
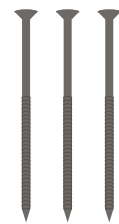
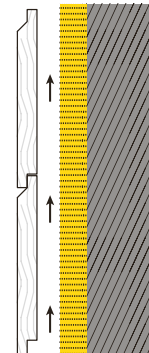

4. Installation

For vertical installation: start on the left side and overlap as you move towards to the right. Visible rabbet should be on the right side.

For horizontal installation: start at the bottom and overlap as you move upwards. Visible rabbet should be on up.

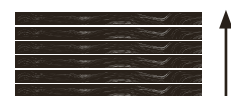
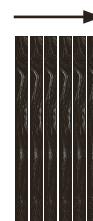

Montage

YAKISUGI

**NAKAMOTO
FORESTRY**
EUROPE

PLEASE READ THIS BEFORE INSTALLING OUR PRODUCTS

AFTER INSTALLATION

1. After-treatment

For optimum protection, all cuts and end-grain wood edges, as well as minor blemishes should be treated directly with the touch-up oil supplied with our shipment.



2. Cleansing

After successful installation, our Yakisugi / Shou Sugi Ban should be carefully cleansed to remove dust and minor dirt. Please apply clean water with a soft brush or damp cloth. Rubbing too hard on the surface or using a stiff brush or a power washer should be avoided.

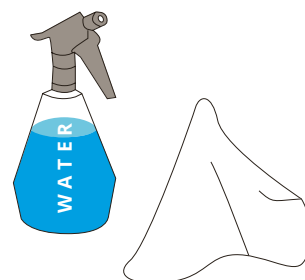

Enjoy your Yakisugi-Siding!

your Nakamoto Forestry Europe Team